

Courses and Distances }
down Elk Lick Creek.

- S. 67° E. -- 56. perches
- S. 62° E. -- 24.
- S. 53° E. -- 26.
- N. 63° E. -- 5.
- N. 28° E. -- 25.
- N. 21½ W. -- 8.
- N. 25½ E. -- 52.
- N. 86° E. -- 18.
- N. 20° E. -- 25. to 239.

the Mouth of the Creek thence
down Castleman's River
N. 34° W. 55 perches to a
Cherry tree on the bank
thence across the River.

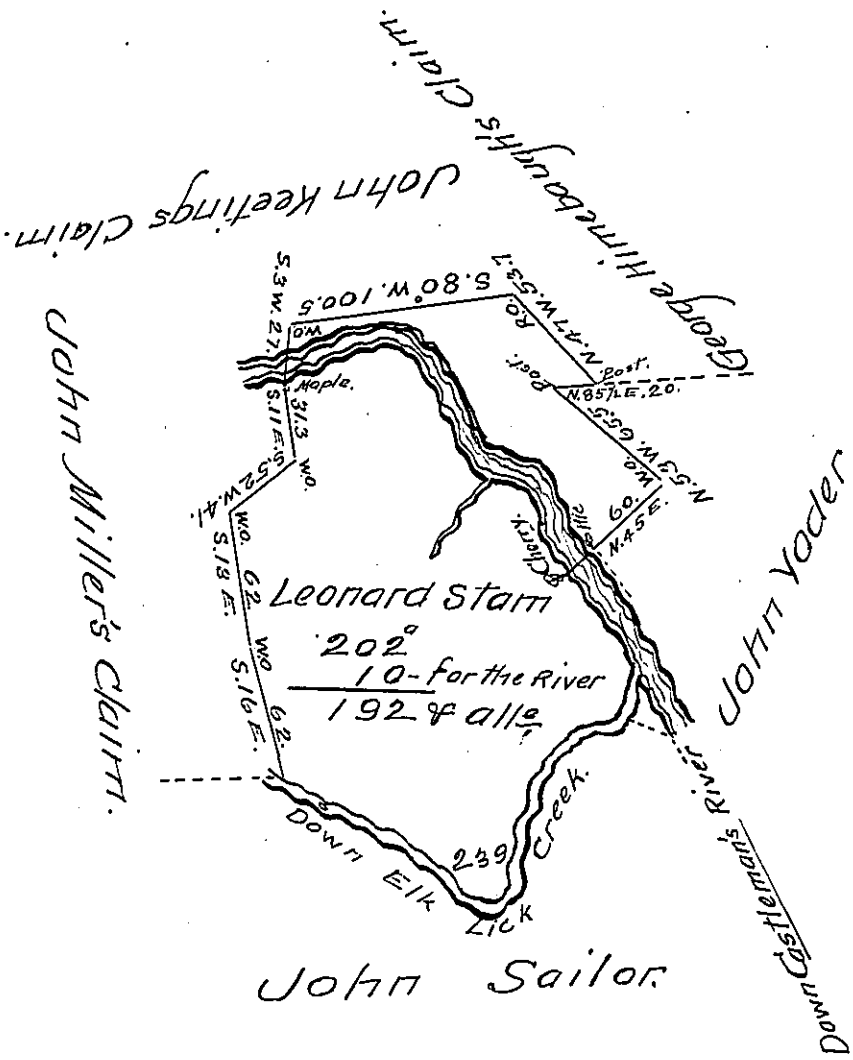

Situated on Castleman's River and Elk Lick
Creek below the forks including his improvement in
Brothers Valley Township Bedford County, and sur-
veyed the 2^d day of October 1786 in Pursuance of a
Warrant dated the 28th day of July 1785.

for Alexander McClean Esq^r

To John Lukens Esq^r }
Surveyor General }

D.S.

Thomas Vickroy.

Now in Elk Lick Township Somerset County.

IN TESTIMONY that the above is a copy of the original remaining on file in
the Department of Internal Affairs of Pennsylvania, made
conformably to an Act of Assembly approved the 16th day of
February 1833, I have hereunto set my hand and caused
the Seal of said Department to be affixed at Harrisburg,
this eleventh day of January 1907.

Loac R Brown

Secretary of Internal Affairs.